

THE DISTRICT ON GARDINERS

PRICE LIST

OCCUPANCY: LATE 2025

KINGSTON, ON

MULTI-PHASE DEVELOPMENT

STARTING PRICES: MORE UNITS AVAILABLE

SUITE	FLOORPLAN	BEDS	BATHS	SIZE	EXPOSURE	PRICES STARTING FROM:
334	Studio A	0	1	501 SQ.FT.	N, Courtyard	\$331,900.00
308	1Cdi	1	1	536 SQ.FT.	W	\$353,900.00
222	1Cgi	1	1	538 SQ.FT.	S	\$357,900.00
326	1Cfi	1	1	540 SQ.FT.	E	\$361,900.00
216	1C	1	1	553 SQ.FT.	W, Courtyard	\$362,900.00
106	2DiB	1+D	1	695 SQ.FT.	W	\$442,900.00
218	2Dic	1+D	1	723 SQ.FT.	S	\$457,900.00
609	2Dia	1+D	1	687 SQ.FT.	W	\$468,900.00
231	2Aif	1+D	2	759 SQ.FT.	W, Courtyard	\$469,900.00
214	2Aid	1+D	2	769 SQ.FT.	S	\$475,900.00
105	2Aa	2	2	824 SQ.FT.	NW	\$494,900.00
615	2Fi	1+D	2	764 SQ.FT.	S	\$500,900.00
220	2Ci	1+D	2	864 SQ.FT.	S	\$534,900.00
204	2A	2	2	895 SQ.FT.	NE, Courtyard	\$540,900.00
210	2Ab	2	2	954 SQ.FT.	SW	\$575,900.00
223	2Ba	2	2	1045 SQ.FT.	S	\$630,900.00
219	2H	2	2	1141 SQ.FT.	S	\$687,900.00

ABOUT DISTRICT ON GARDINERS

The District on Gardiners provides a great opportunity for modern living in a community with a multitude of historic roots. The site is strategically located giving the residents' an outstanding sense of convenience as it is situated near all of the everyday shops you would need. There is also a variety of restaurants, shopping malls, and parks merely minutes away, while also being near the main arteries of the city. Additionally, The District on Gardiners is only 5 minutes away from the core of a vibrant downtown and Queen's University.

CONTACT US

Phone: (416) 549 - 4915

Email: sham@cvre.ca

Website: <https://thedistrictkingston.com/>

THE DISTRICT

ON GARDINERS

DISTRICT ON GARDINERS - HOMEBUYER INCENTIVES

- **Extended 20% Deposit Structure**
- **2 Year Project Management**
- **Free Assignment**
- **12 Month Leaseback**
 - For the Leaseback Program Amendment, the Builder will manage the initial lease process to qualify the tenant and collect rent cheques.
 - A 12 month lease will be entered with the Tenant and Purchaser to ensure the purchaser can apply for the HST rebate
 - \$1,650.00 for 1 Beds
 - \$2,350.00 for 1 Bed + Dens
 - \$100.00 for Parking

THE DISTRICT ON GARDINERS

INVESTOR - LEASEBACK SUITES

THE DISTRICT ON GARDINERS

Unit 2Dia 9 Total

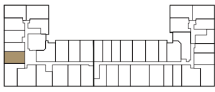

Indoor Living Space
687 SF

Outdoor Living Space
32 SF

Any dimensions, materials and/or specifications outlined, described or depicted in any plan, sketch or drawing attached as a schedule for the agreement of purchase and sale (or to the disclosure statement) are subject to change without notice. Actual usable floor space may vary from any stated or depicted floor area. The exterior elevations and site plan of the Condominium are subject to approval by the applicable governmental authorities, and accordingly are subject to any changes required by said authorities. The locations and specifications of any windows, doors, and/or any balcony and/or any terrace areas, shown or depicted on any plan, sketch or layout of the unit, are subject to change without notice, and may vary (and be reversed in location or orientation) depending on the location of the unit within the project. All illustrations so depicted on any plans or drawings pertaining to the unit or the Condominium building (or any portion thereof) are reflective of the artist's concept only. E. & O.E. October 1st, 2022.

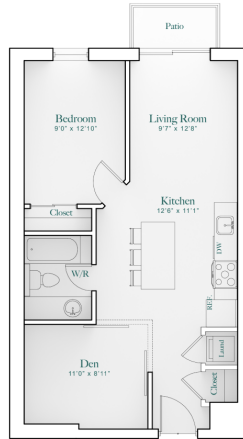

THE DISTRICT ON GARDINERS

Unit 2Dib 6 Total



Indoor Living Space
695 SF

Outdoor Living Space
32 SF

Any dimensions, materials and/or specifications outlined, described or depicted in any plan, sketch or drawing attached as a schedule for the agreement of purchase and sale (or to the disclosure statement) are subject to change without notice. Actual usable floor space may vary from any stated or depicted floor area. The exterior elevations and site plan of the Condominium are subject to approval by the applicable governmental authorities, and accordingly are subject to any changes required by said authorities. The locations and specifications of any windows, doors, and/or any balcony and/or any terrace areas, shown or depicted on any plan, sketch or layout of the unit, are subject to change without notice, and may vary (and be reversed in location or orientation) depending on the location of the unit within the project. All illustrations so depicted on any plans or drawings pertaining to the unit or the Condominium building (or any portion thereof) are reflective of the artist's concept only. E. & O.E. October 1st, 2022.

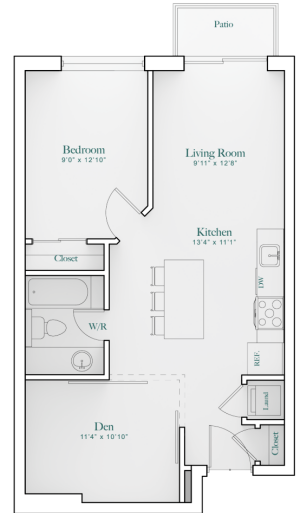

THE DISTRICT ON GARDINERS

Unit 2Dic 15 Total

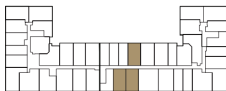

Indoor Living Space
723 SF

Outdoor Living Space
32 SF

Any dimensions, materials and/or specifications outlined, described or depicted in any plan, sketch or drawing attached as a schedule for the agreement of purchase and sale (or to the disclosure statement) are subject to change without notice. Actual usable floor space may vary from any stated or depicted floor area. The exterior elevations and site plan of the Condominium are subject to approval by the applicable governmental authorities, and accordingly are subject to any changes required by said authorities. The locations and specifications of any windows, doors, and/or any balcony and/or any terrace areas, shown or depicted on any plan, sketch or layout of the unit, are subject to change without notice, and may vary (and be reversed in location or orientation) depending on the location of the unit within the project. All illustrations so depicted on any plans or drawings pertaining to the unit or the Condominium building (or any portion thereof) are reflective of the artist's concept only. E. & O.E. October 1st, 2022.

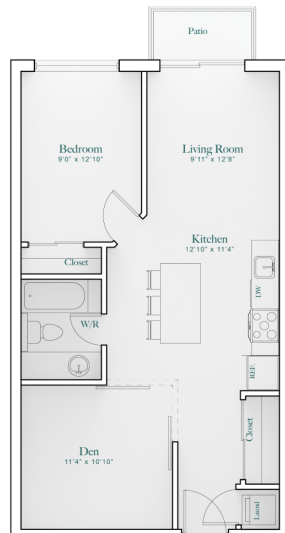

THE DISTRICT ON GARDINERS

Unit 2Did 5 Total



Indoor Living Space
692 SF

Outdoor Living Space
32 SF

Any dimensions, materials and/or specifications outlined, described or depicted in any plan, sketch or drawing attached as a schedule for the agreement of purchase and sale (or to the disclosure statement) are subject to change without notice. Actual usable floor space may vary from any stated or depicted floor area. The exterior elevations and site plan of the Condominium are subject to approval by the applicable governmental authorities, and accordingly are subject to any changes required by said authorities. The locations and specifications of any windows, doors, and/or any balcony and/or any terrace areas, shown or depicted on any plan, sketch or layout of the unit, are subject to change without notice, and may vary (and be reversed in location or orientation) depending on the location of the unit within the project. All illustrations so depicted on any plans or drawings pertaining to the unit or the Condominium building (or any portion thereof) are reflective of the artist's concept only. E. & O.E. October 1st, 2022.

